

INDUSTRIAL COMPUTING



Visualize



Edge Computing



Fanless IM1260



- Scalable performance: Intel Core i3, i5, i7 – 13/14th generation
- Dual GLAN
- Up to 2x RS232 (422/485) optional

4x M3 on the bottom
depth: 3 mm

Fanless IM1250 is a solid and reliable general purpose fanless IPC

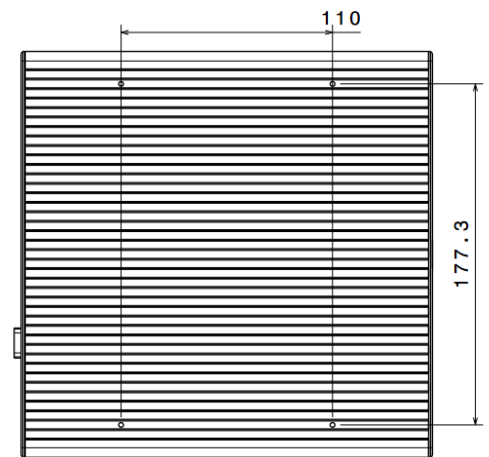

Untersicht
Maßstab: 1:2

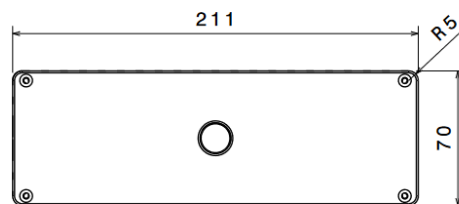

Seitenansicht rechts
Maßstab: 1:2

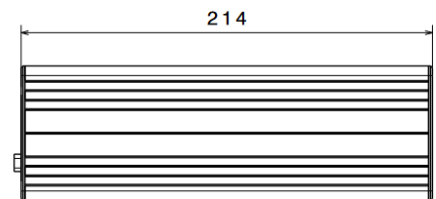

Vorderansicht
Maßstab: 1:2

IPC
FANLESS IM1260

PN: 90000038

Issued: 04/24
Status: released

Factsheet

Physical properties	
Chassis	Full-metal aluminium construction, black anodized
Dimensions	214x211x70 mm (WxDxH)
Cooling	Passive by heatpipes
Mounting options*	Mounting threads on the bottom, DIN-rail, VESA, wall, 19" bracket
Weight	2,5 kg
Hardware	
Formfactor	Mini-ITX
CPU	Intel Core i3 14100 Intel Core i5 14500 Intel Core i7 14700 @35W TDP
RAM	4, 8, 16, 32, 64 GB DDR4
Storage	1x 250GB – 2TB m.2, 2x 250GB – 4TB 2.5"
Graphics	Intel HD, 1x HDMI 2.0, 1x Displayport
Communication	
WLAN*	802.11 b/g/n/ac + Bluetooth
LTE*	4G / 5G module
Others	-
I/O	
I/O front	- up to 2x USB 2.0 + 1x RS232 + 1x RS232/422/485
I/O back	2x USB 3.2gen1, 2x USB 3.2gen 2x1, 2x RJ GLAN, 1x HDMI, 1x DP, 2x Audio
I/O internal**	4x USB 2.0, 1x LVDS, 1 RS232, 1x RS232/422/485, 2x SATA, 1x m.2 key E, 1x m.2 key M, 8x GPIO, 1x I2C/Smbus, 1x Frontpanel Header, 1x AT/ATX mode switch
Power supply	
PSU	150W external adapter
Power input	12V / 19..24V DC, 5.5x2.5 mm barrel plug, optional: PhoenixContact plug
Redundancy	-
Power draw	Idle: ~9W, full-load: ~45W
Compatibility	
OS	Windows 10 / 11 (IoT), Linux
Others	
Environment	
Operating temp. range / Humidity	0..50°C / 10...95%, non-condensing
Protection class	IP50
Compliance	
Conformity	CE, RoHS, REACH
General	
Scope of delivery	IPC, documentation, PSU, certificate of conformity
Language	EN, DE
Long-term-availability	Until 2029
Warranty	3 years, optional 4, 5 years*
Country of Origin	Germany
Tariff code	84715000

*Depending on actual system configuration / may require optional accessory

**Maybe occupied due to actual system configuration